

P2 Mechanics and Scattering Chamber

P2 Retreat 24.06.2025

P2: CAD drawing

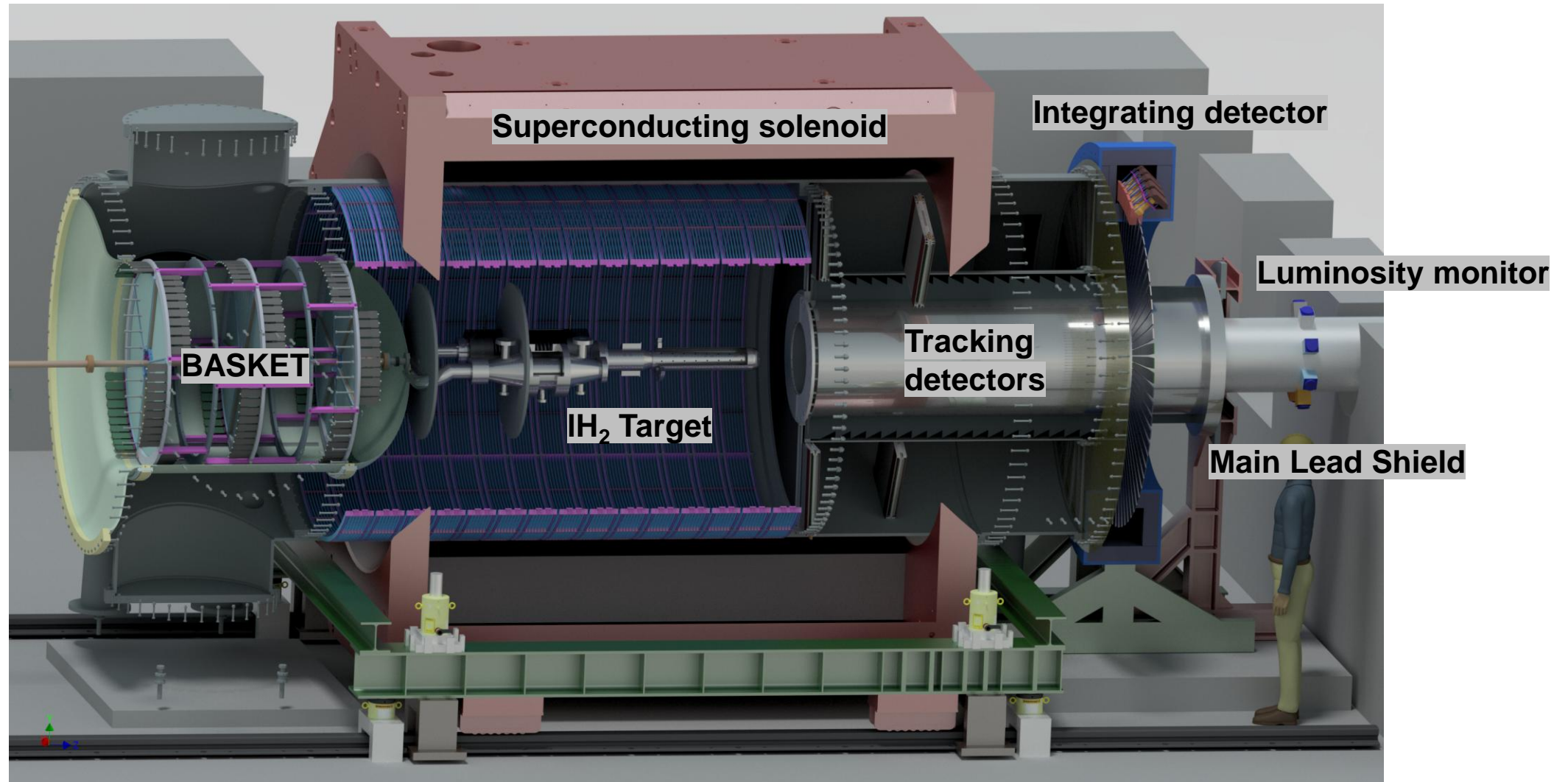

Vacuum chamber

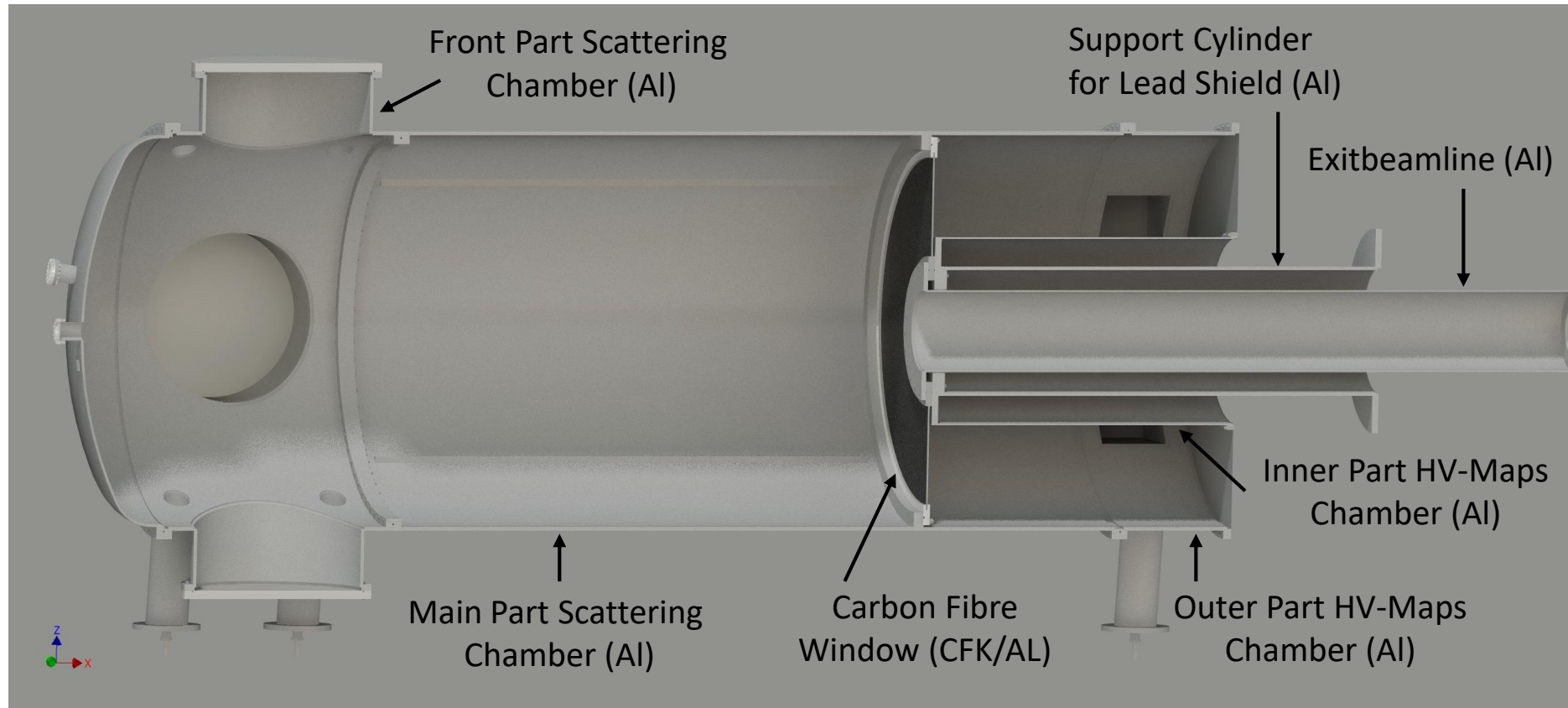

- Delivered
- Manufacturer: NTG (Gelnhausen)

CFK Window

- CFK Window missing, waiting for Offer (Schunk KohlenstoffTechnik GmbH)
- Calculated/simulated by Schunk
- Design is fixed
- Slight donut shape
- Thickness 1,5 cm
- Diameter 2,1 m
- Flanges will be manufactured by NTG

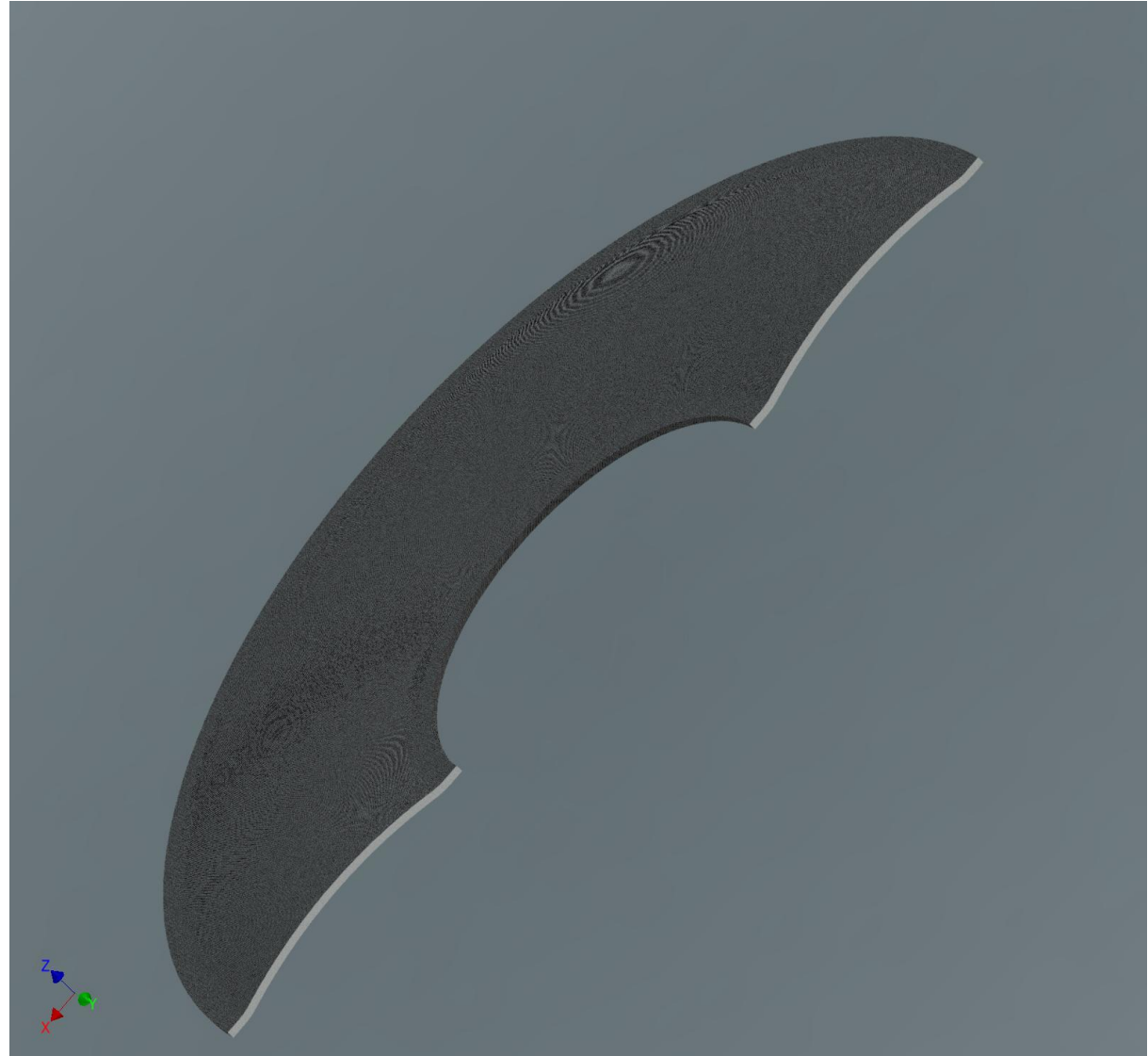

Missing Support

- Vacuum chamber still floating
- Will use same system as for Solenoid fine adjustment
- Size depends on left space for feet beam downstream

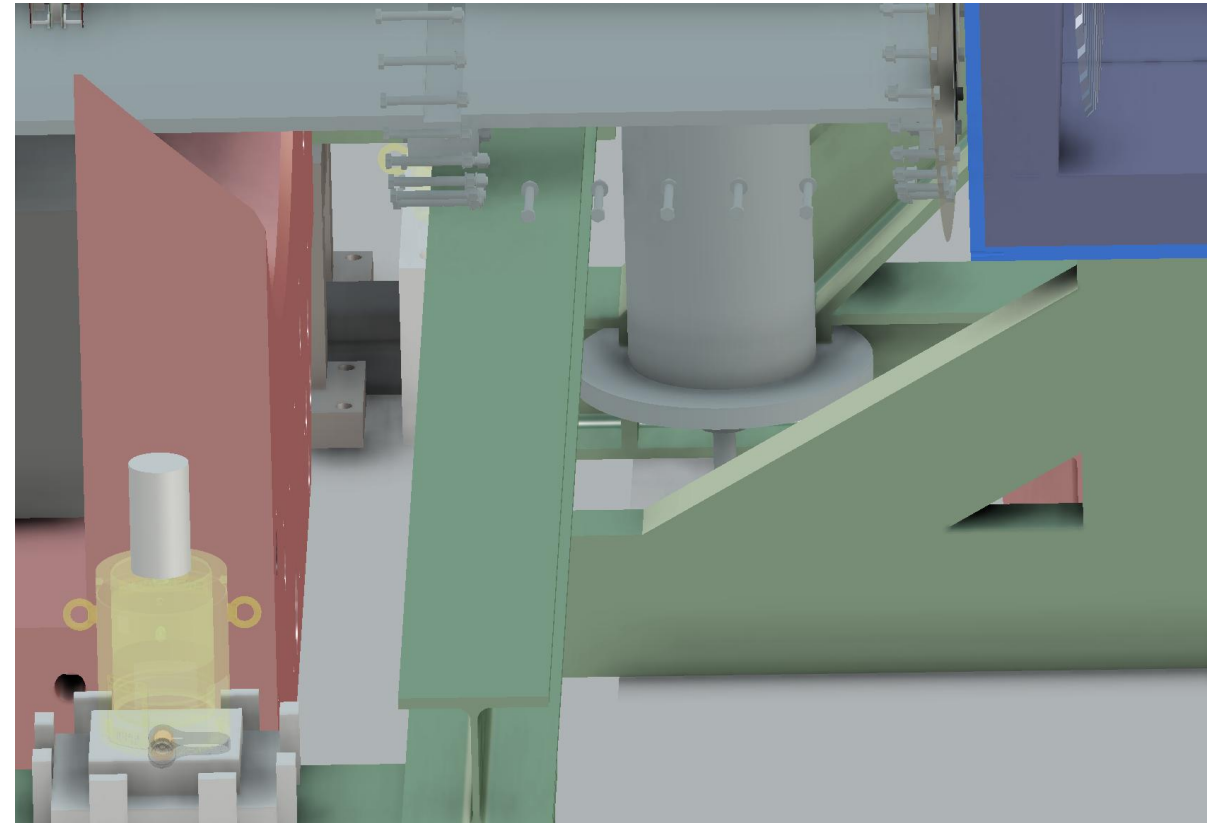
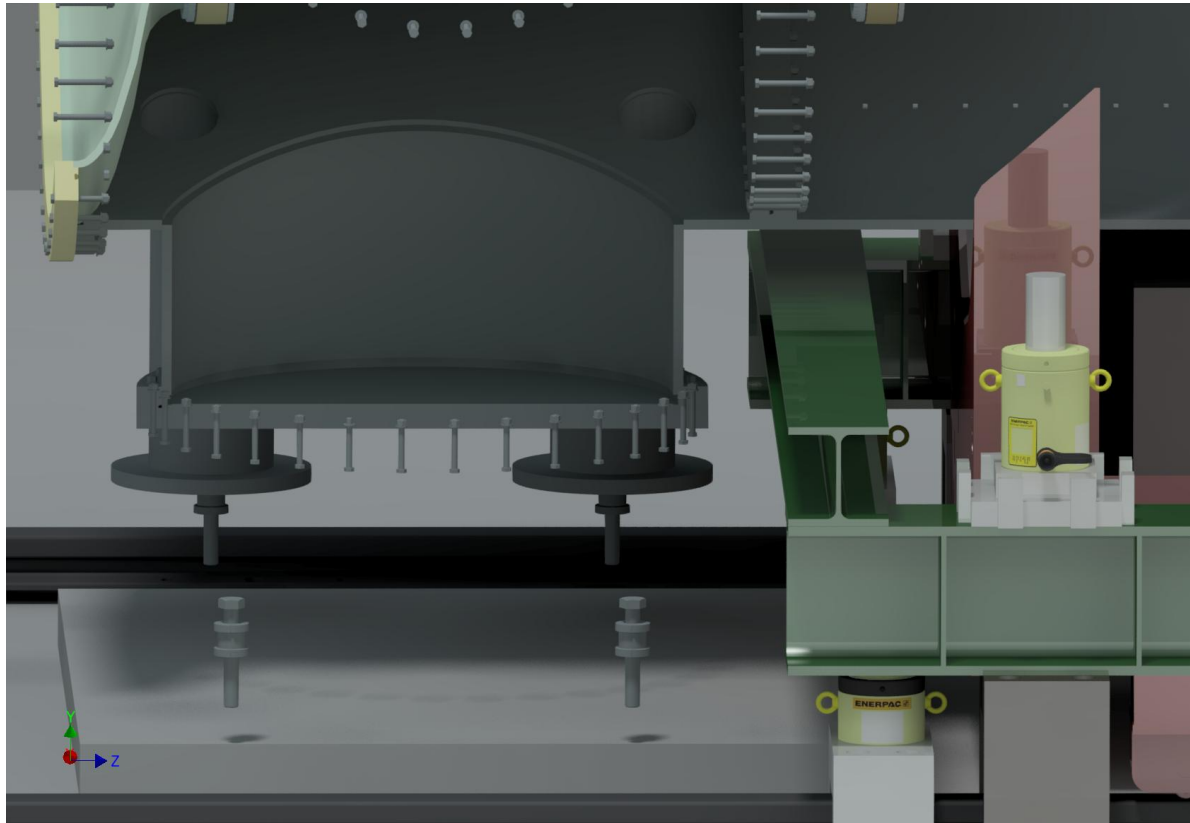

Main Lead Shield

- Waiting for offer from NTG
- NTG will provide the support and the main cylinder
- To provide deflection the support will be fixed in the bottom and the wall (not shown)
- Lead already delivered

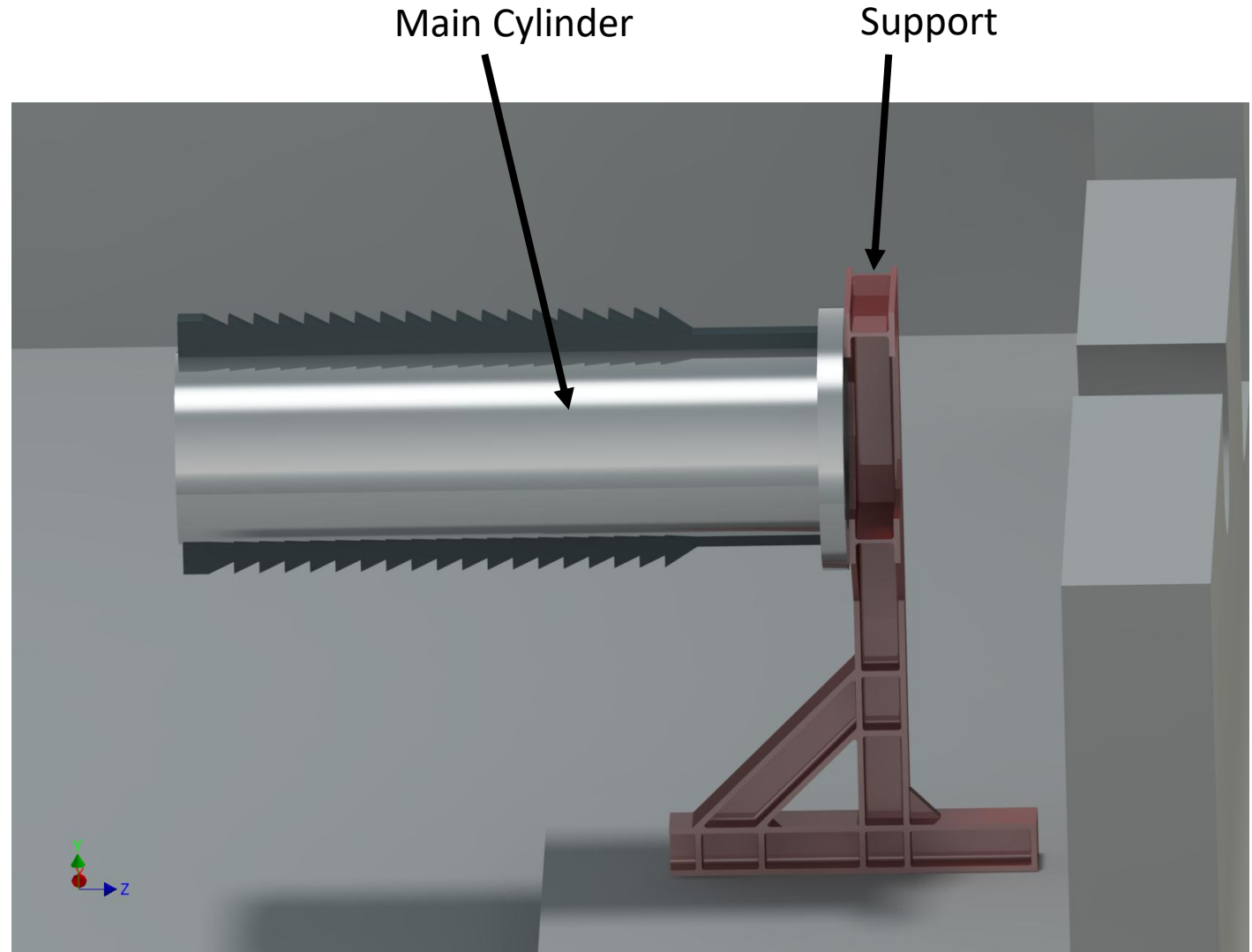

Housing and Shielding for Main Detector

- Details will be shown by Rahima
- New support with rails is under construction
- Rails will be requested soon
- Housing and shielding is ordered from MTH and will be delivered in October

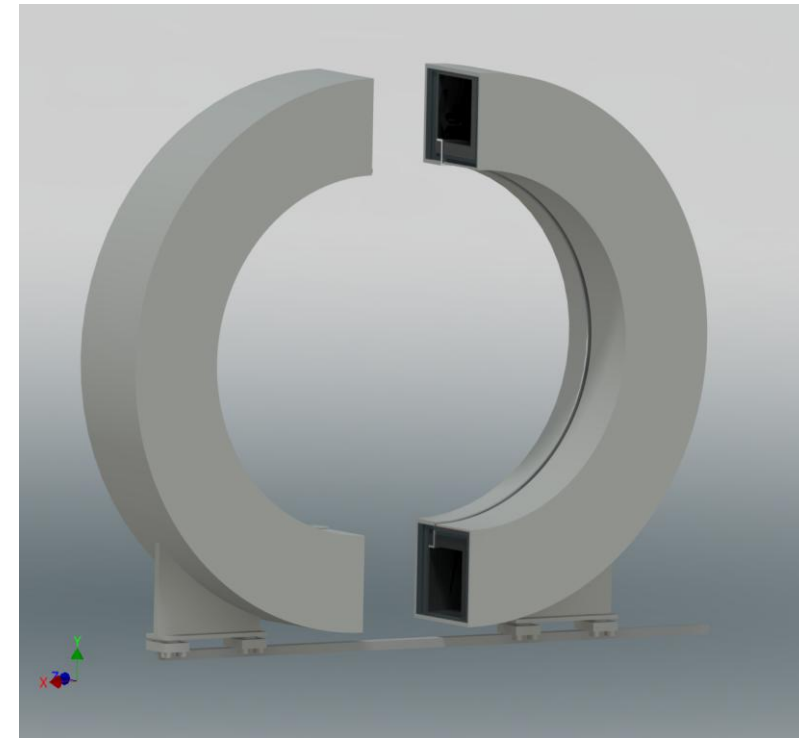
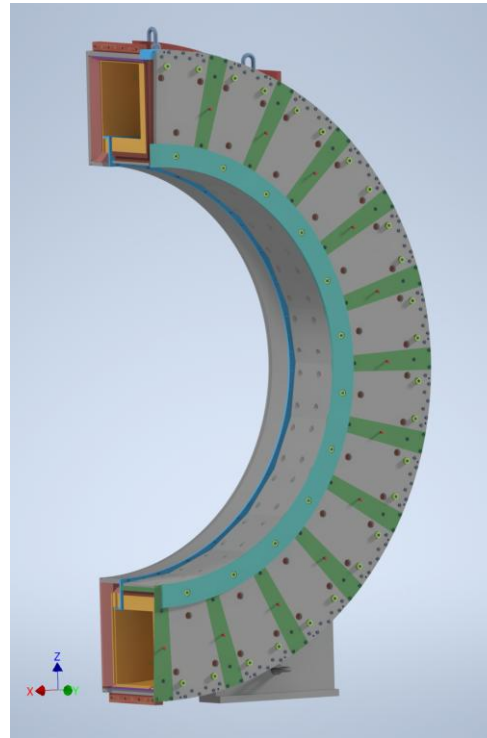
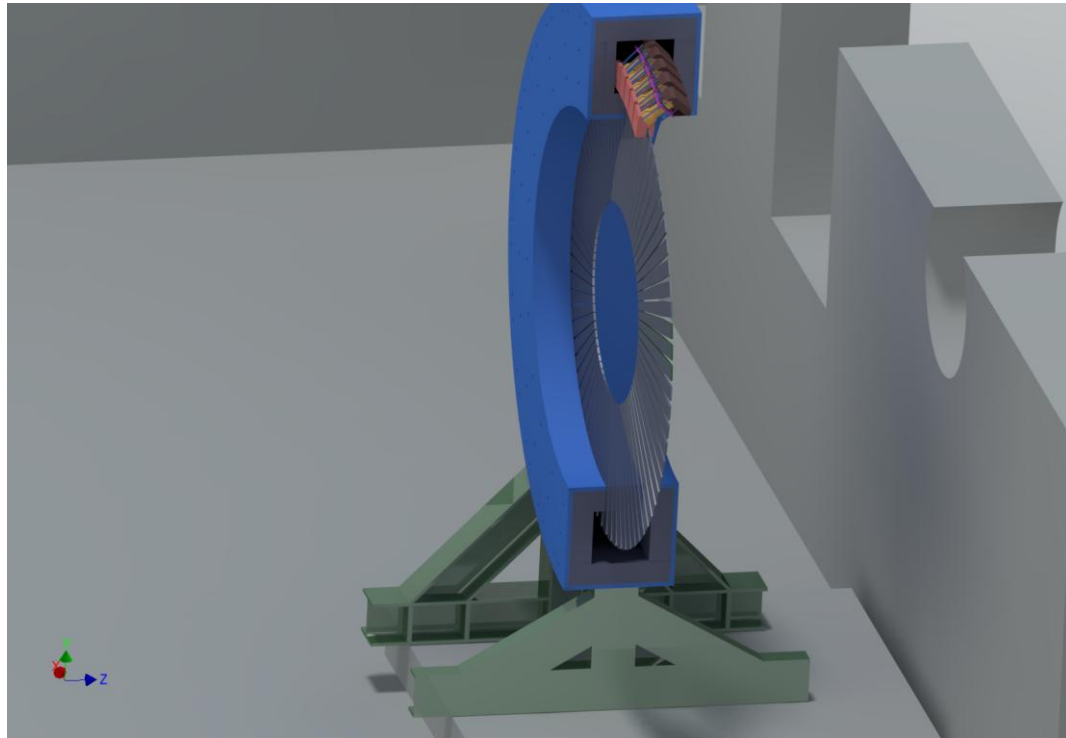

Exit Beamline and Lumi

- Lumi details will be shown by Tobias
- New Lumi design is fixed
- Construction is ongoing with Paul
- Anchoring of exit beamline is under construction with Paul

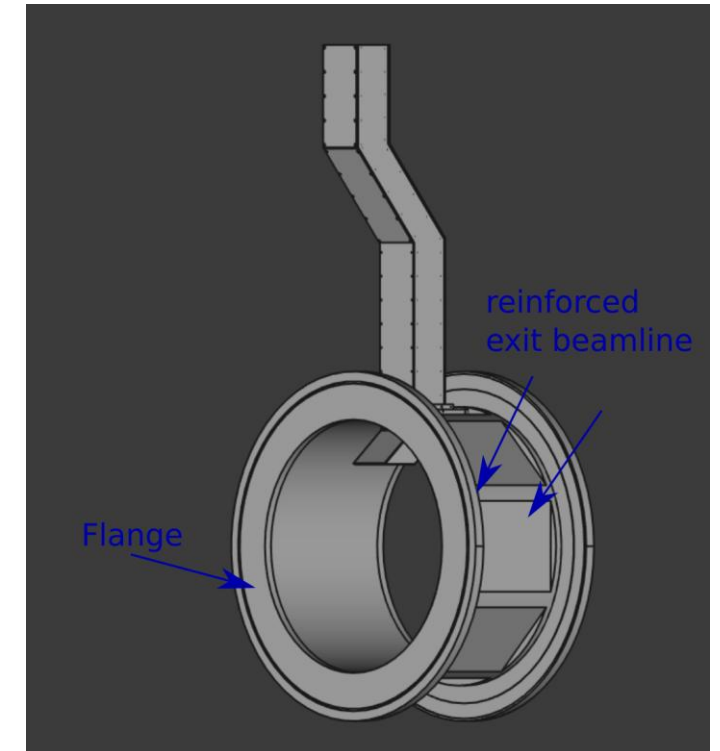
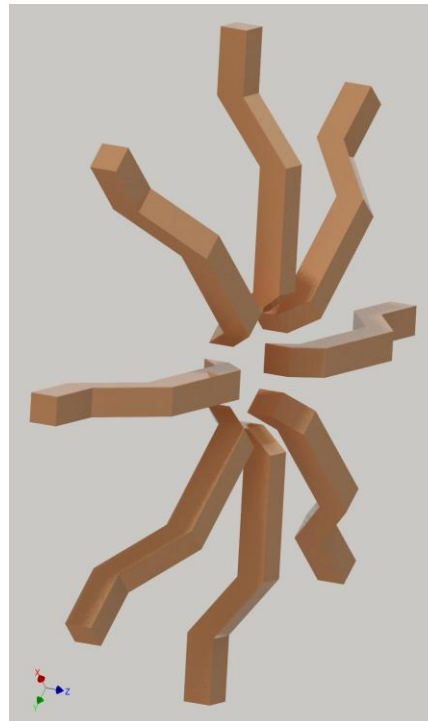
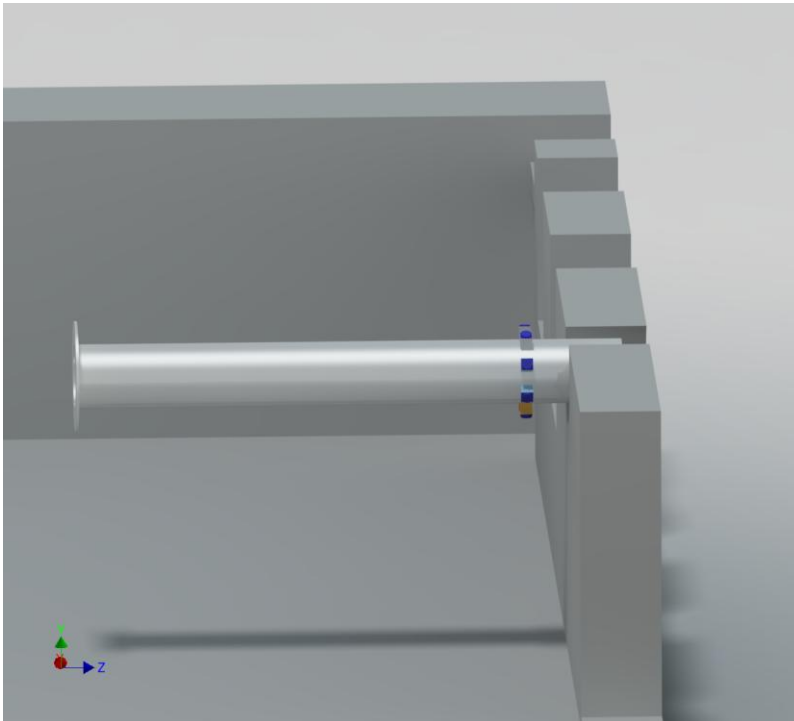

Target Support

- Idea of target support
- Decoupled from scattering chamber
- NTG interested in development
- Movement in vacuum and with non magnetic materials in the chamber

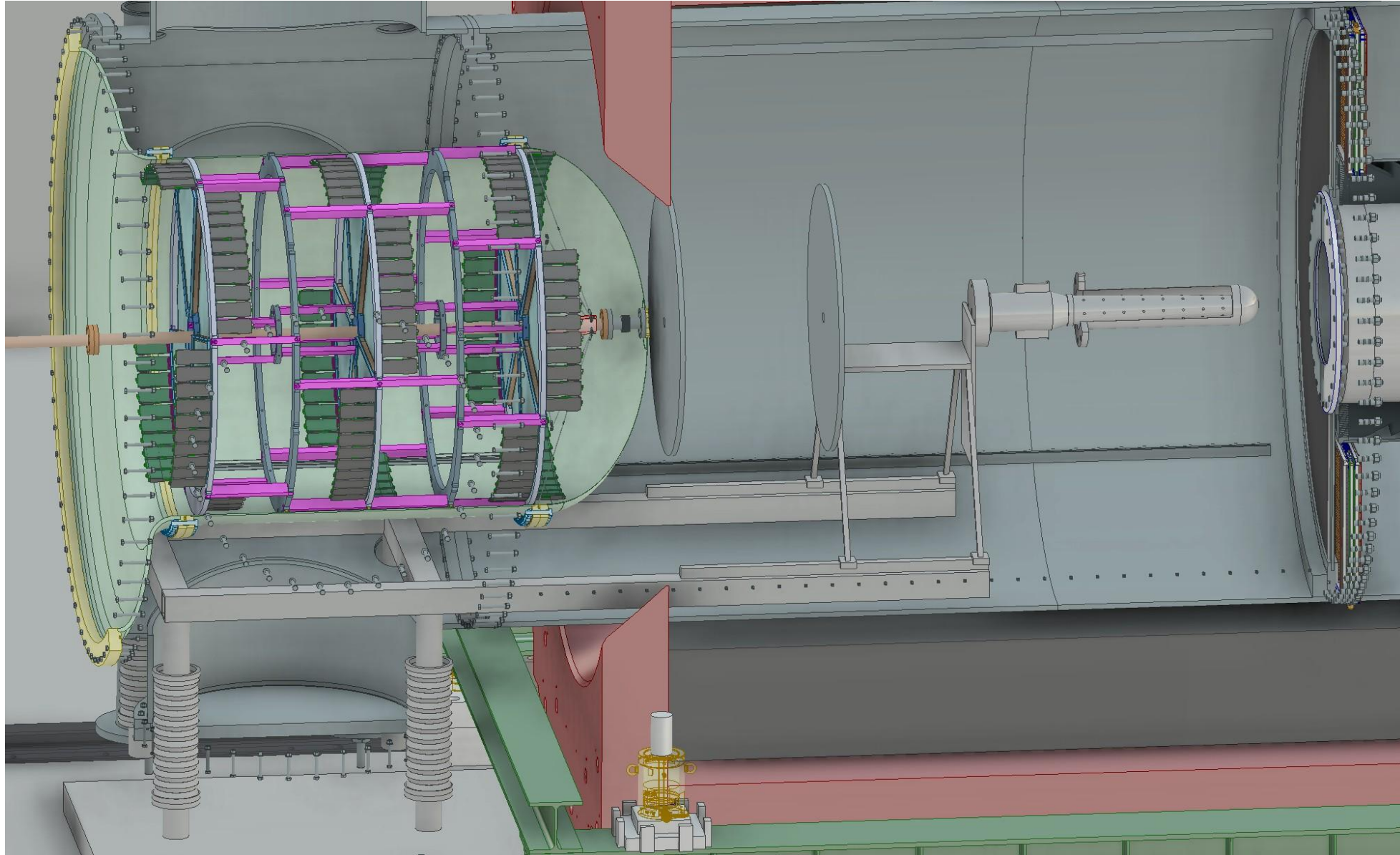

Thank You